

1.5.4

Available

Floor	5
Rooms	1,5
Apartment area without partitions (PBP)	35,39 m ²
Apartment area with partitions (PSP)	34,41 m ²
Window orientation	South



VISORIŲ ST. 10, VILNIUS

ON THE PROJECT PLAN

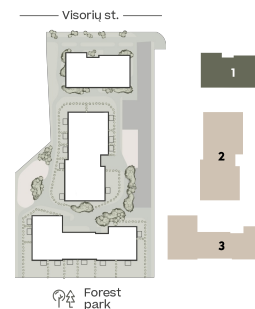

ON THE FLOOR



More information

info@visi-savi.lt

+370 643 57 258

www.visi-savi.lt



1.5.4

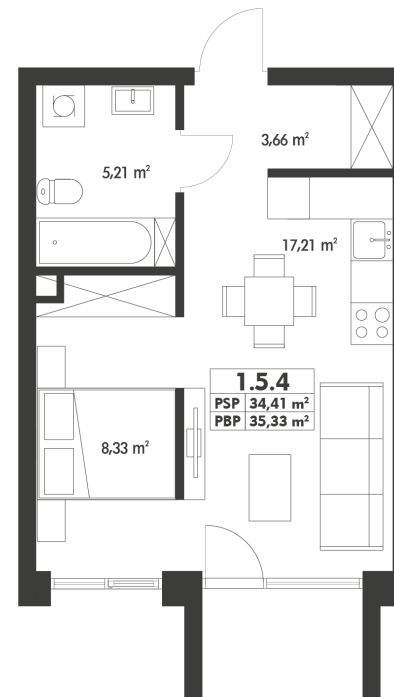

 Visualisations represent the vision of the project. Apartment plans are of recommendatory nature. Apartments are sold without partitions.

More information

info@visi-savi.it

+370 643 57 258

www.visi-savi.lt

