

# 2.4.5

 Sold

Floor	4
Rooms	1
Apartment area without partitions (PBP)	26,35 m <sup>2</sup>
Apartment area with partitions (PSP)	26,19 m <sup>2</sup>
Window orientation	West



VISORIŲ ST. 10, VILNIUS

ON THE PROJECT PLAN

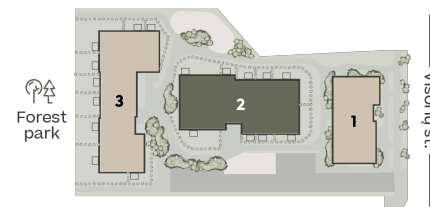

ON THE FLOOR



More information [info@visi-savi.lt](mailto:info@visi-savi.lt)

+370 643 57  
258

[www.visi-savi.lt](http://www.visi-savi.lt)



# 2.4.5

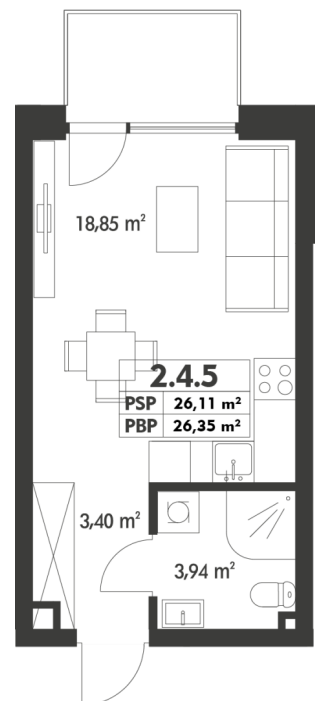

 Visualisations represent the vision of the project. Apartment plans are of recommendatory nature. Apartments are sold without partitions.

More information

[info@visi-savi.it](mailto:info@visi-savi.it)

+370 643 57  
258

[www.visi-savi.lt](http://www.visi-savi.lt)

